

GRAND FORKS  
COUNTY HIGHWAY DEPARTMENT

**BIDDERS PROPOSAL**

COUNTY WIDE PAVEMENT MARKING

PROJECT CWPM-1800(020)

240.857 MILES

PAVEMENT MARKING PAINTED LINE & MESSAGE

COUNTY WIDE

GRAND FORKS COUNTY

DATE OF LETTING: MARCH 31, 2020

PROPOSAL OF:

GRAND FORKS COUNTY COMMISSIONERS

ADVERTISEMENT FOR BIDS

NOTICE TO PAVEMENT MARKING CONTRACTORS:

By the order of the Board of County Commissioners of Grand Forks County, North Dakota, I hereby give notice that sealed bids will be received by the undersigned at the office of the County Director of Finance & Tax up until 10:30 o'clock a.m., March 31, 2020. Bids will be publicly opened and read at 10:30 a.m. for Pavement Marking Painted Line & Message, for the county, as per specifications prepared by and available at the office of the County Highway Department, Located at 1700 N. Columbia Road, Grand Forks. Bids shall be considered April 7, 2020 Commission meeting.

In compliance with Section 11-11-28 of the North Dakota Century, bids to be opened and considered must be accompanied by a bond. A bid shall be accompanied by a separate envelope containing a bidder's bond in a sum equal to five percent of the full amount of the bid, executed by the bidder's as principal and by a surety company authorized to do business in the State as a guaranty that the bidder will enter into the contract if it is awarded to him and he will furnish the necessary bond. Also to be included with the envelope containing the bid bond shall be the contractor's license.

The Board reserves the right to reject any or all bids, in whole or in part, and to waive any technicalities.

The Board reserves the right to extend the date of receiving and opening of bids for a period of not to exceed five days when unforeseeable events may warrant such extension, at the discretion of the Board.

Bids must be enclosed in a sealed envelope, with a separate envelope for the bidder's bond and contractors license both addressed to the County Director of Finance & Tax and Marked on the outside what the bid is for. The County Director of Finance & Tax is located at 151 4<sup>th</sup> Street South and there mailing address is P.O. Box 5726, Grand Forks, ND 58206.

Dated at Grand Forks, North Dakota, this 3<sup>rd</sup> day of March 2020.

Debbie Nelson  
County Director of Finance & Tax  
Grand Forks, North Dakota

(Publish March 7, 14, 21, 2020)

LEGAL NOTICE

## GRAND FORKS COUNTY HIGHWAY DEPARTMENT

## INSTRUCTION TO BIDDERS

I. Proposals are requested for the construction of Pavement Marking Painted Line & Message, Grand Forks County Highway Department Project No. CWPM-1800(020). in accordance with Plans, North Dakota Standard Specification Manual, North Dakota Supplemental Specification and other Contract Documents prepared by the Grand Forks County Highway Department.

A. Form: Each Proposal shall be made in a form prepared there for by the Engineer and included as one of the Contract Documents. All bids and proposals shall contain a statement showing that the bidder or contractor is dully and regularly licensed in the State of North Dakota. The number and class of the license then held by the contractor shall appear upon each bid or proposal. No contract shall be awarded to any contractor unless he is a holder of a license in the class within which the value of the project shall fall as hereinbefore provided. A contractor must be the holder of a license at least ten days prior to the date set for receiving bids to be qualified bidder. The bid shall be submitted in a sealed envelope upon which there is disclosed the following information:

1. The class of license held by the bidder;
2. The number of the bidder's license;
3. The name of the person, firm or corporation submitting the bid;
4. Date on which license was issued or renewed.
5. Certification of Insurance not less than 1,000,000.00 dollars.
6. 5% Bid Bond

A bid submitted without this information on the envelope shall not be considered and shall be returned to the bidder.

B. Modifications; Proposal shall not contain any recapitulation of the work to be done. Alternate proposals will not be considered unless called for. Oral proposals or modification will not be considered.

C. Examination of Contract Documents and Visit to Site;

Before submitting proposal, Bidder's shall carefully examine the Plans, read the Specification and the other Contract Document, shall visit the site of work, and shall fully inform themselves as to all existing conditions, and limitations, and shall include in the proposal a sum to cover the cost of items included in the Contract Documents.

D. Deliver of Proposal; Proposals shall be delivered by the time and the place stipulated in the Advertisement. It is the sole responsibility of the Bidder to see that his proposal received in proper time. Any proposal received after the scheduled closing time for receipt of proposals shall be returned to the Bidder unopened.

E. Withdrawal; Any Bidder may withdrawal his proposal, either personally or by written request, at any time prior to the scheduled closing time for receipt of proposals.

F. Opening; Proposals will be opened and publicly read aloud at the time and place set forth in the Advertisement.

G. Award or Rejection; The Contract will be awarded to the lowest and/or best qualified responsible Bidder complying with those instructions and with the Advertisement. Grand Forks County reserves the right to reject any or all proposals or to waive any informalities or technicality in any proposal in the interest of Grand Forks County. No bidder may withdraw his proposal for a period of 30 days after the date of opening thereof.

- II INTERPRETATION OF DOCUMENTS; If any person contemplating submitting a proposal is in doubt as to the true meaning of an part of the Plans, Specifications or other Contract Documents, or finds discrepancies in or omissions from the Plans or Specifications, he may submit to the Engineer a written request for an interpretation or correction thereof. The person submitting the request will be responsible for its prompt delivery. Any interpretation or correction of the documents will be made only by Addendum duly issued and a copy of the Addendum will be mailed or delivered to each person receiving a set of the Contract Documents. Neither the County nor the Engineer will be responsible for any other explanation or interpretation of the Contract Documents.
- III ADDENDA; Any addenda issued during the time of bidding, or forming part of the Contract Documents loaned to the Bidder for the preparation of his proposal, shall be covered in the proposal, and shall be made a part of the Contract. Receipt of each Addendum shall be acknowledged in the proposal.
- IV BIDDERS INTERESTED IN MORE THAN ONE PROPOSAL; No person, firm or corporation shall be allowed to make, file or to be interested in more than one proposal for the same work, unless alternate proposals are called for. A person firm or corporation who has submitted a sub-proposal to a Bidder's, or who has quoted prices on materials to a Bidder's is not hereby disqualified from submitting a sub-proposal or quoting prices to other Bidder's.
- V PROPOSAL GUARANTY; Each bid must be accompanied by a bidder's bond in the amount of 5 percent of the bid, payable to Grand Forks County. All bonds shall comply with the North Dakota Century Code as amended.
- All such bonds will be returned to the respective unsuccessful Bidder's within ten days after the award is made, except those the County elects to hold until the successful Bidder has executed the Contract. Thereafter all remaining bonds will be returned within ten days.
- VI CERTIFICATE FROM TAX COMMISSIONER; In accordance with Section 43-07-11.1 of the North Dakota Century Code, prior to executing the Contract, the contractor shall submit to Grand Forks County a certificate from and by the Tax Commissioner stating that the Contractor has paid all delinquent income taxes if any, owed to the State pursuant to the provisions of Chapter 57-38 of the above mention code.
- VII GOVERNING SPECIFICATION; Standard Specification for Road and Bridge Construction adopted by the North Dakota Department of Transportation October, 2014 shall apply to this Contract.

Note: The envelope containing this proposal should be marked: Proposal for Grand Forks County Highway Department Project No. CWPM-1800(020) County Wide Pavement Marking items, in Grand Forks County.

\*\*\*\*\*

(Proposal of Name) \_\_\_\_\_

(Address) \_\_\_\_\_

to furnish and deliver all material and to do and perform all work, in accordance with the Standard Specification, adopted by the North Dakota Department of Transportation October 2014. Standard Drawings currently in effect, and other Contract Provisions submitted herein, of the Grand Forks County Highway Department except as specifically stated otherwise in the "Special Provisions" contained therein, for the improvement of a certain section of County Highway in Grand Forks County, State of North Dakota,

on which proposal will be accepted until 10:30 o'clock a.m., on the 31 day of March 2020, this highway being known as Grand Forks County Highway Department.

Project No. CWMP-1800(020)

\*\*\*\*\*

To the County Engineer of the Grand Forks County Highway Department Grand Forks, North Dakota

Sir:

In accordance with Advertisement and Notice to Contractors of the Grand Forks County Highway Department, inviting proposals for the improvement of the section of highway hereinbefore named, and in conformity with the plans and specification, on file in the office of the Grand Forks County Highway Department, I/We hereby certify that I am/we are the only person or persons interested in this proposal as principals; that it is made without collusion with any person, firm or corporation; that an examination has been made of the specifications and Contract Form including "Special Provisions" contained therein, also the Plans, and the site of the work, and propose to furnish all necessary machinery, equipment, tools labor and other means of construction, and to furnish all materials specified, in the manner and at the time specified and understand that the quantities of work as shown herein are approximate only and are subject to increase or decrease, and further understand that all quantities of work whether increased or decreased, are to be preformed at the following unit prices (except as provided in said specification)

The Highway Department reserves the right to reject any or all bids, in whole or in part, and to waive any technicalities.

**Quotes By: March 00, 2020**

**Quotes**

2020 Grand Forks County Wide Pavement Marking

**Project: CWPM-1800(020)**

DESCRIPTION	PVMT MK PNTD 4" LINE	PVMT MK PNTD 8" LINE	PVMT MK MESSAGE	ROADWAY MILES
County Road No. 1	75,224	0	854	31.936
County Road No. 2	79,335	0	721	30.937
County Road No. 3	70,726	0	0	5.257
County Road No. 4 & Demers Ave	126,663	0	152	21.223
County Road No. 4A & 4B	76,710	0	304	4.964
County Road No. 5	88,114	0	813	12.579
County Road No. 6	77,222	520	577	17.391
County Road No. 7	0	0	0	0
Belmont Road	4,328	130	92	1.003
County Road No. 10	38,256	0	380	14.818
County Road No. 11	132,879	0	228	23.257
County Road No. 12	20,614	0	493	9.178
County Road No. 13	12,813	0	152	5.103
County Road No. 17	11,544	130	244	4.810
County Road No. 19	10,241	0	76	3.010
County Road No. 21	3,444	0	76	0.582
County Road No. 23	11,929	0	76	5.080
County Road No. 25	11,027	0	285	2.038
County Road No. 26	13,152	0	152	6.106
32 <sup>nd</sup> Ave. South	6,199	0	209	3.012
County Road No. 33	79,545	0	550	23.498
County Road No. 81	18,964	650	80	6.522
County Road No. 81A	0	0	0	0
<b>TOTAL</b>	<b>968,929</b>	<b>1,595</b>	<b>6,514</b>	<b>240.857</b>

Pavement Marking Painted 4 In Line      968,929 LF x \_\_\_\_\_ = \_\_\_\_\_  
 Pavement Marking Painted 8 In Line      1,595 LF x \_\_\_\_\_ = \_\_\_\_\_  
 Pavement Marking Painted - Message      6,514 LF x \_\_\_\_\_ = \_\_\_\_\_  
  
**TOTAL COST**      = \_\_\_\_\_

GRAND FORKS COUNTY HIGHWAY DEPARTMENT

PROPOSAL

It is further proposed that this bidder will:

Do all "Extra Work" which may be required to complete the work contemplated at the unit prices or lump sums, to be agreed upon in writing prior to starting such extra work or if such price or sums cannot be agreed upon, to perform such work on a "Force Account" basis, as provided for in the specifications.

Obtain all required license and authority as may be required by law or foreign corporations prior to executing the contract and agrees that failure to do so shall constitute a default and grounds for forfeiture of proposal guarantee.

Begin work within ten calendar days from the date of the "Notice to Proceed" and to prosecute said work so as to complete the roadway and its appurtenances on or before **September 30, 2020**.

Comply with requirements of Title 65, North Dakota Century Code, as amended, known as the Workmen's Compensation Act.

\_\_\_\_\_  
Contractor

By \_\_\_\_\_

Title \_\_\_\_\_

Dated \_\_\_\_\_, 2020

GRAND FOR COUNTY HIGHWAY DEPARTMENT

CONTRACT

This agreement made and entered into by the Grand Forks County Highway Department, party of the first part, and

\_\_\_\_\_  
PARTY OF THE SECOND PART (hereinafter called Contractor), WITNESSETH:

1. That, for and in consideration of the payments hereinafter mention to be made by the party of the first part, the Contractor promised and agrees to furnish and deliver all the material and to do and perform all the work and labor required to be furnished and delivered, and to pay or cause to be paid as they become due, all claims for any work or labor performed including that performed repairing machinery and equipment, or renting any equipment and machinery or furnishing any, hand tools, or materials or insurance premiums or supplies used for machinery and equipment, all as done and performed in and about the improvement and construction of a certain portion of the public highway

known as Grand Forks County. Highway Department Project Number CWPM-1800(020)

in Grand Forks County, North Dakota for Pavement Marking Painted Line & Message. In accordance with item numbers and quantities listed in the proposal and the limits of Projects as shown in the plans approved by the County Engineer of Grand Forks County Highway Dep't. a length of 240.857 miles in strict and entire conformity with provisions of this contract, and bond and proposal, and the plans and specifications approved by the County Engineer, copies of which are hereto attached, and which said plans and specifications and proposal and bond are hereby made a part of this agreement. As fully and to the same effect as if the same had been set forth in the body of this agreement.

2. The party of the first part agrees and promised to pay to the Contractor for said work, when completed and accepted in accordance with the provisions of this contract, the price set forth in the said proposal, amounting approximately to

\_\_\_\_\_  
payment to be made as provided in said specification upon presentation of the proper certification of the County Engineer of the Grand Forks County Highway Department, or his representatives, and under to terms of this contract.

3. The said work shall be done in accordance with the terms of this agreement and the laws of the State of North Dakota under direct supervision and to the entire satisfaction of the Grand Forks County Highway Department.

4. The decision of said County Engineer upon any question connected with the execution of this agreement or any failure or delay in the prosecution of the work by the said Contractor shall be final and conclusive.

5. The Contractor shall begin construction work when so ordered by the Grand Forks County Highway Department and shall maintain at all times thereon a maximum and effective force.

6. The Said work shall be completed by September 30, 2020.

In Witness Whereof, the parties to this contract have hereunto set their hand and seals this \_\_\_\_\_ day of \_\_\_\_\_, 2020.

GRAND FORKS COUNTY STATE OF NORTH DAKOTA

\_\_\_\_\_  
Chairman of the Board of Grand Forks County  
Commissioner, Party of the First Part

WITNESS TO CONTRACTOR'S SIGNATURE

\_\_\_\_\_  
Grand Forks County Director of Finance & Tax

Contractor

By \_\_\_\_\_

Title \_\_\_\_\_

Party of the Second Part









**PLANS**  
 For The Proposed Improvement  
**GRAND FORKS COUNTY HIGHWAY**  
 2020 COUNTY WIDE PAVEMENT MARKING

PCN	State	Project No.	Sheet No.
	ND	CWPM-1800(020)	1

**GOVERNING SPECIFICATIONS**

Standard Specifications for Road and Bridge Construction  
 2014 Standard Specifications adopted by the NDDOT and  
 the Supplemental Specifications effective on the date the  
 project is advertised.

-  U.S. Highway
-  State Highway
-  County Highway
-  County Gravel
-  County Highway To Be Pavement Marked
-  County Highway NOT To Be Pavement Marked

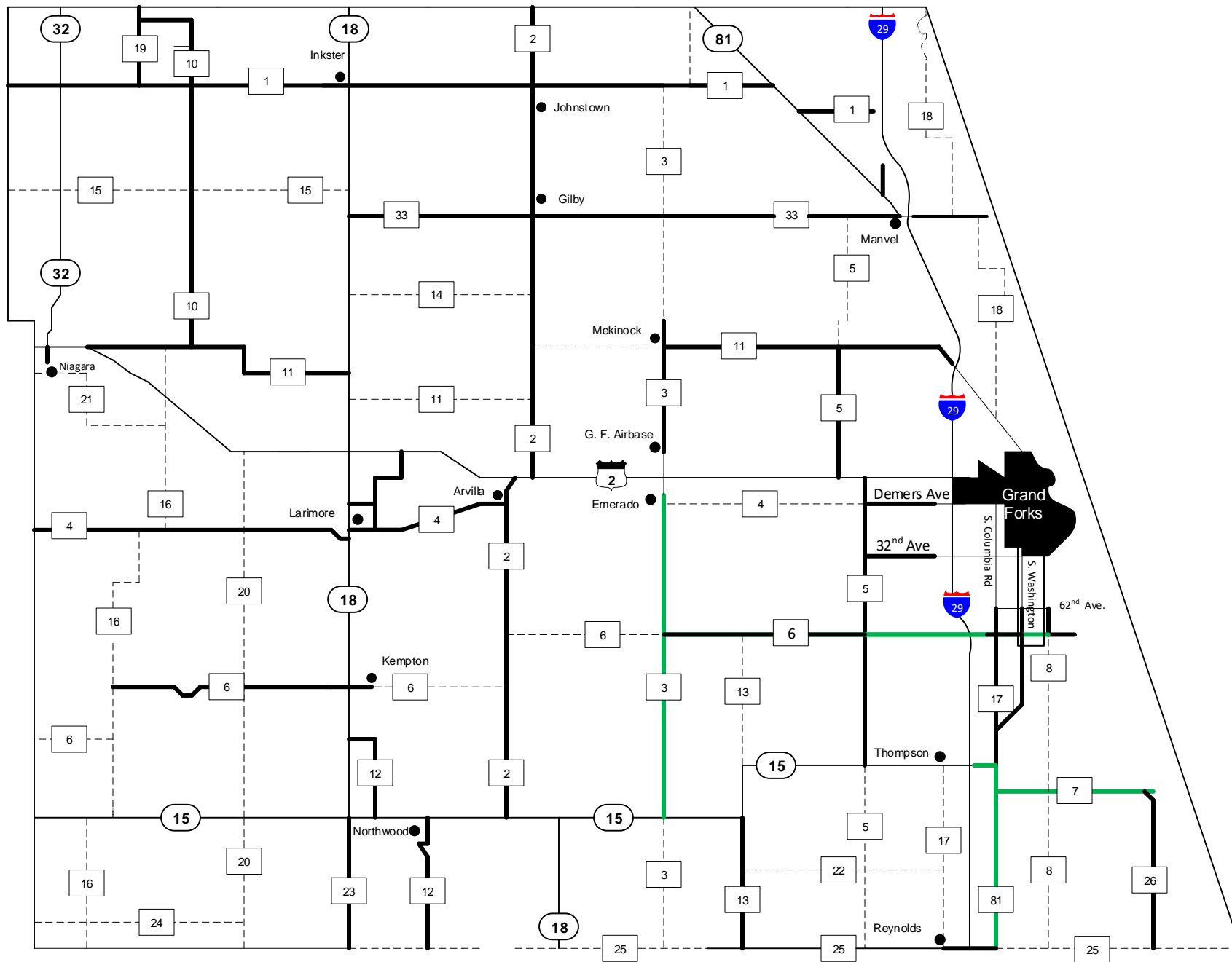

POC: Scott Clayton  
 P.O. Box 5682  
 Grand Forks, ND 58206  
 (701) 780-8248

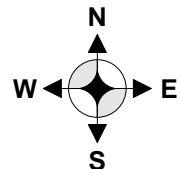

This document was originally  
 Issued and sealed by  
 Nicholas J. West  
 Registration Number PE-5961  
 On 03-05-2020  
 Document is stored at the  
 Grand Forks County Highway  
 Department

## TABLE OF CONTENTS

PCN	State	Project No.	Sheet No.
	ND	CWPM-1800(020)	2

Page #	Description	Number	Description
1.	Title Sheet	D-704-27	Traffic Control Plan for Moving Operation
2.	Table of Contents	D-762-1	Pavement Marking Message Detail
3.	Notes	D-762-4	Pavement Marking
4.	Estimate of Quanties	D-762-5	Pavement Marking for Standard 90 Degree Flared Intersection
5.	Basis of Estimate	D-762-6	Pavement Marking for Standard 90 Degree Flared Intersection
6.	Basis of Estimate		
7.	Basis of Estimate		
8.	Basis of Estimate		
9.	Basis of Estimate		
10.	Basis of Estimate		
11.	Basis of Estimate		
12.	Basis of Estimate		
13.	Basis of Estimate		
14.	Pavement Marking Installation Detail		

This document was originally  
 Issued and sealed by  
 Nicholas J. West  
 Registration Number PE-5961  
 On 03-05-2020  
 Document is stored at the  
 Grand Forks County Highway  
 Department

**NOTES**

PCN	State	Project No.	Sheet No.
	ND	CWPM-1800(020)	3

100 PROJECT COORDINATION: Coordinate with Engineer at least one week prior to beginning work to determine if roadway segments are prepared for work to begin.

762 TRAFFIC CONTROL FOR PAVEMENT MARKING OPERATION: Maintain traffic at all times. Provide traffic control based on the following list:

1. D-704-27

Include all costs associated with traffic control for painting pavement markings in the contract unit price "PVMT MK PAINTED 4IN LINE".

762 ESTIMATED QUANTITIES: The total pavement marking quantity is to the nearest whole number for bidding purposes.

762 EDGE LINE: Discontinue edge line for Township, and City roads, and where curb and gutter is present.

This document was originally  
Issued and sealed by  
Nicholas J. West  
Registration Number PE-5961  
On 03-05-2020  
Document is stored at the  
Grand Forks County Highway  
Department

ESTIMATE OF QUANTITIES

PCN	State	Project No.	Sheet No.
	ND	CWPM-1800(020)	4

762 0103	PVMT MK PAINTED – MESSAGE	SF	6,514
762 1104	PVMT MK PAINTED 4" LINE	LF	968,929
762 1108	PVMT MK PAINTED 8" LINE	LF	1,595

This document was originally  
 Issued and sealed by  
 Nicholas J. West  
 Registration Number PE-5961  
 On 03-05-2020  
 Document is stored at the  
 Grand Forks County Highway  
 Department

BASIS OF ESTIMATE

PCN	State	Project No.	Sheet No.
	ND	CWPM-1800(020)	5

ROUTE	LOCATION	FROM REF. POINT	TO REF. POINT	ROADWAY (MILES)	4" EDGE LINE (L.F.)	4" CENTERLINE (L.F.)	4" NPZ BARRIER (L.F.)	8" TURNING LANE (L.F.)	RR CROSSING (S.F.)	TURNING ARROW (S.F.)	STOP AHEAD MESSAGE (S.F.)
CR #1	FROM NELSON COUNTY LINE TO NDSH #32	0.000	1.996	1.996	21,077	1,996	9,034				76
CR #1	FROM NDSH #32 TO CR #19	1.996	5.004	3.008	31,770	3,809	4,248				76
CR #1	FROM CR #19 TO NDSH #18	5.004	13.041	8.037	77,785	10,280	8,252				76
CR #1	FROM NDSH #18 TO CR #2	13.041	20.059	7.018	74,110	8,990	5,470		133		76
CR #1	FROM CR #2 TO US #81	20.059	29.328	9.269	97,881	12,115	6,531		265		76
CR #1	FROM US #81 TO WEST ENTRANCE TO I-29	29.328	31.936	2.608	27,488	3,436	729				76
<b>CR #1</b>	<b>SUBTOTAL</b>			<b>31.936</b>	<b>0</b>	<b>40,960</b>	<b>34,264</b>	<b>0</b>	<b>398</b>	<b>0</b>	<b>456</b>

Routes colored in green are NOT to have pavement marking.

This document was originally  
 Issued and sealed by  
 Nicholas J. West  
 Registration Number PE-5961  
 On 03-05-2020  
 Document is stored at the  
 Grand Forks County Highway  
 Department

BASIS OF ESTIMATE

PCN	State	Project No.	Sheet No.
	ND	CWPM-1800(020)	6

ROUTE	LOCATION	FROM REF. POINT	TO REF. POINT	ROADWAY (MILES)	4" EDGE LINE (L.F.)	4" CENTERLINE SKIP (L.F.)	4" NPZ BARRIER (L.F.)	8" TURNING LANE (L.F.)	RR CROSSING (S.F.)	TURNING ARROW (S.F.)	STOP AHEAD MESSAGE (S.F.)
CR #2	FROM NDSH #15 TO U.S. #2	31.936	44.750	12.814	136,522	15,540	20,472		265		76
CR #2	FROM U.S. #2 TO CR #33 - GILBY	44.750	54.848	10.098	106,636	12,883	13,267				152
CR #2	FROM CR #33 TO CR #1 - JOHNSTOWN	54.848	59.866	5.018	52,992	5,870	6,684				152
CR #2	FROM CR #1 TO WALSH COUNTY LINE	59.866	62.873	3.007	31,754	3,969	650				76
<b>CR #2</b>	<b>SUBTOTAL</b>			<b>30.937</b>	<b>0</b>	<b>38,262</b>	<b>41,073</b>	<b>0</b>	<b>265</b>	<b>0</b>	<b>456</b>

CR #3	FROM NDSH #15 TO EMERADO	67.914	80.836	12.922	179,547	15,414	17,849		265		76
CR #3	FROM EAST ENTRANCE GFAPB TO MEKINOCK	80.836	85.603	5.257	55,616	6,344	8,766				
<b>CR #3</b>	<b>SUBTOTAL</b>			<b>5.257</b>	<b>55,616</b>	<b>6,344</b>	<b>8,766</b>	<b>0</b>	<b>0</b>	<b>0</b>	<b>0</b>

Routes colored in green are NOT to have pavement marking.

This document was originally  
 Issued and sealed by  
 Nicholas J. West  
 Registration Number PE-5961  
 On 03-05-2020  
 Document is stored at the  
 Grand Forks County Highway  
 Department

**BASIS OF ESTIMATE**

PCN	State	Project No.	Sheet No.
	ND	CWPM-1800(020)	7

ROUTE	LOCATION	FROM REF. POINT	TO REF. POINT	ROADWAY (MILES)	4" EDGE LINE (L.F.)	4" CENTERLINE SKIP (L.F.)	4" NPZ BARRIER (L.F.)	8" TURNING LANE (L.F.)	RR CROSSING (S.F.)	TURNING ARROW (S.F.)	STOP AHEAD MESSAGE (S.F.)
CR #4	FROM NELSON COUNTY LINE TO NDSH #18 - LARIMORE	97.67	109.877	12.207	128,902	15,523	20,216				76
CR #4	FROM NDSH #18 TO HALSEY ST. - ARVILLA	109.877	116.119	6.242	63,316	7,082	15,584				
DEMERS	FROM 16 <sup>TH</sup> ST. NE TO GRAND FORKS CITY LIMITS	124.929	127.703	2.774	29,300	3,663	1,279				76
CR #4A & 4B	FROM CR #4 TO U.S. #2 & NDSH #18 TO CR #4A	127.703	132.667	4.964	52,420	4,911	19,379				304
<b>CR #4</b>	<b>SUBTOTAL</b>			<b>26.187</b>	<b>115,736</b>	<b>31,179</b>	<b>56,458</b>	<b>0</b>	<b>0</b>	<b>0</b>	<b>456</b>

CR #5	FROM NDSH #15 TO CR #6	139.681	144.710	5.029	53,112	6,639	1,300				152
CR #5	FROM CR #6 TO U.S. #2	144.710	150.736	6.026	63,630	7,269	9,542	165	265	16	152
17 <sup>TH</sup> ST NE	FROM U.S. #2 TO 23 <sup>RD</sup> AVE NE	150.736	155.774	5.038	53,210	6,651	1,300				152
CR #5	FROM U.S. #81 TO DEAD END	160.895	162.223	1.328	14,022	1,753	450				76
<b>CR #5</b>	<b>SUBTOTAL</b>			<b>17.391</b>	<b>53,210</b>	<b>22,312</b>	<b>12,592</b>	<b>165</b>	<b>265</b>	<b>16</b>	<b>532</b>

Routes colored in green are NOT to have pavement marking.

This document was originally  
 Issued and sealed by  
 Nicholas J. West  
 Registration Number PE-5961  
 On 03-05-2020  
 Document is stored at the  
 Grand Forks County Highway  
 Department

**BASIS OF ESTIMATE**

PCN	State	Project No.	Sheet No.
	ND	CWPM-1800(020)	8

ROUTE	LOCATION	FROM REF. POINT	TO REF. POINT	ROADWAY (MILES)	4" EDGE LINE (L.F.)	4" CENTERLINE SKIP (L.F.)	4" NPZ BARRIER (L.F.)	8" TURNING LANE (L.F.)	RR CROSSING (S.F.)	TURNING ARROW (S.F.)	STOP AHEAD MESSAGE (S.F.)
CR #6	FROM CR #16 TO KEMPTON	165.229	174.229	9.712	102,556	10,999	32,423		133		228
CR #6	FROM CR #3 TO CR #5	186.524	195.430	8.906	94,044	11,749	7,000				76
12 <sup>TH</sup> AVE NE	FROM CR #5 TO WEST OF CR #17	195.430	200.240	4.810	50,790	5,986	5,486		265		
12 <sup>TH</sup> AVE NE	FROM WEST OF CR #17 TO CR #81	200.240	201.457	1.217	12,852	1,004	6,226	390		48	76
12 <sup>TH</sup> AVE NE	FROM CR #81 TO CR #8	201.457	202.462	1.005	10,612	1,166	2,301	260		32	152
12 <sup>TH</sup> AVE NE	FROM CR #8 TO COUNTRY CLUB	202.462	203.489	1.027	10,850	779	7,042	130		16	
<b>CR #6</b>	<b>SUBTOTAL</b>			<b>20.862</b>	<b>0</b>	<b>24,531</b>	<b>52,691</b>	<b>520</b>	<b>133</b>	<b>64</b>	<b>380</b>

CR #7	FROM CR #81 TO RED RIVER BRIDGE	203.489	209.639	6.150	64,940	6,498	12,426				76
<b>CR #7</b>	<b>SUBTOTAL</b>			<b>0</b>	<b>0</b>	<b>0</b>	<b>0</b>	<b>0</b>	<b>0</b>	<b>0</b>	<b>0</b>

Routes colored in green are NOT to have pavement marking.

This document was originally  
 Issued and sealed by  
 Nicholas J. West  
 Registration Number PE-5961  
 On 03-05-2020  
 Document is stored at the  
 Grand Forks County Highway  
 Department



**BASIS OF ESTIMATE**

PCN	State	Project No.	Sheet No.
	ND	CWPM-1800(020)	9

ROUTE	LOCATION	FROM REF. POINT	TO REF. POINT	ROADWAY (MILES)	4" EDGE LINE (L.F.)	4" CENTERLINE (L.F.)	4" NPZ BARRIER (L.F.)	8" TURNING LANE (L.F.)	RR CROSSING (S.F.)	TURNING ARROW (S.F.)	STOP AHEAD MESSAGE (S.F.)
BELMONT ROAD	FROM 12 <sup>TH</sup> AVE. NE TO 62 <sup>ND</sup> AVE. SOUTH	221.646	222.649	1.003	10,680	1,059	3,269	130		16	76
<b>BELMONT ROAD</b>	<b>SUBTOTAL</b>			<b>1.003</b>	<b>0</b>	<b>1,059</b>	<b>3,269</b>	<b>130</b>	<b>0</b>	<b>16</b>	<b>76</b>

CR #10	FROM CR #11 TO CR #1	235.671	245.737	10.066	106,294	12,615	9,992				152
CR #10	FROM CR #1 TO CR #19	245.737	250.235	4.498	47,494	5,383	9,730				152
	FROM FORDVILLE DAM ENTRANCE TO CR #10	250.235	250.995	0.254	2,680	335	201				76
<b>CR #10</b>	<b>SUBTOTAL</b>			<b>14.818</b>	<b>0</b>	<b>18,333</b>	<b>19,923</b>	<b>0</b>	<b>0</b>	<b>0</b>	<b>380</b>

CR #11	FROM US #2 TO NDSH #18	250.995	261.386	10.391	109,726	12,082	25,821				152
CR #11	FROM CR #3 TO CR #5	273.473	281.265	7.792	82,282	9,839	16,238				76
23 <sup>RD</sup> AVE. NE	FROM CR #5 TO I-29 OFF RAMP	281.265	286.609	5.344	56,428	6,948	5,523				
<b>CR #11</b>	<b>SUBTOTAL</b>			<b>23.527</b>	<b>56,428</b>	<b>28,869</b>	<b>47,582</b>	<b>0</b>	<b>0</b>	<b>0</b>	<b>228</b>

Routes colored in green are NOT to have pavement marking.

This document was originally Issued and sealed by Nicholas J. West Registration Number PE-5961 On 03-05-2020 Document is stored at the Grand Forks County Highway Department

**BASIS OF ESTIMATE**

ROUTE	LOCATION	FROM REF. POINT	TO REF. POINT	ROADWAY (MILES)	4" EDGE LINE (L.F.)	4" CENTERLINE (L.F.)	4" NPZ BARRIER (L.F.)	8" TURNING LANE (L.F.)	RR CROSSING (S.F.)	TURNING ARROW (S.F.)	STOP AHEAD MESSAGE (S.F.)
CR #12	FROM CR #25 TO NDSH #15	286.609	291.876	5.267	55,624	6,570	6,059		265		76
CR #12	FROM NDSH #15 TO NDSH #18	291.876	295.787	3.911	41,294	5,162	2,823				152
<b>CR #12</b>	<b>SUBTOTAL</b>			<b>9.178</b>	<b>0</b>	<b>11,732</b>	<b>8,882</b>	<b>0</b>	<b>265</b>	<b>0</b>	<b>228</b>

CR #13	FROM CR #25 TO NDSH #15	295.787	300.890	5.103	53,888	6,118	6,695				152
<b>CR #13</b>	<b>SUBTOTAL</b>			<b>5.103</b>	<b>0</b>	<b>6,118</b>	<b>6,695</b>	<b>0</b>	<b>0</b>	<b>0</b>	<b>152</b>

CR #17	FROM CR #81 TO 62 <sup>ND</sup> AVE. SOUTH	358.209	363.019	4.810	50,788	5,965	5,579	130		16	228
<b>CR #17</b>	<b>SUBTOTAL</b>			<b>4.810</b>	<b>0</b>	<b>5,965</b>	<b>5,579</b>	<b>130</b>	<b>0</b>	<b>16</b>	<b>228</b>

CR #19	FROM CR #1 TO WALSH COUNTY LINE	380.574	383.584	3.010	31,782	3,936	6,305				76
<b>CR #19</b>	<b>SUBTOTAL</b>			<b>3.010</b>	<b>0</b>	<b>3,936</b>	<b>6,305</b>	<b>0</b>	<b>0</b>	<b>0</b>	<b>76</b>

Routes colored in green are NOT to have pavement marking.

This document was originally  
 Issued and sealed by  
 Nicholas J. West  
 Registration Number PE-5961  
 On 03-05-2020  
 Document is stored at the  
 Grand Forks County Highway  
 Department

**BASIS OF ESTIMATE**

PCN	STATE	Project No.	SHEET NO
	ND	CWPM-1800(020)	11

ROUTE	LOCATION	FROM REF. POINT	TO REF. POINT	ROADWAY (MILES)	4" EDGE LINE (L.F.)	4" CENTERLINE SKIP (L.F.)	4" NPZ BARRIER (L.F.)	8" TURNING LANE (L.F.)	RR CROSSING (S.F.)	TURNING ARROW (S.F.)	STOP AHEAD MESSAGE (S.F.)
CR #21	FROM NIAGARA TO U.S. #2	409.616	410.198	0.582	6,156	577	2,867				76
<b>CR #21</b>		<b>SUBTOTAL</b>		<b>0.582</b>	<b>0</b>	<b>577</b>	<b>2,867</b>	<b>0</b>	<b>0</b>	<b>0</b>	<b>76</b>

CR #23	FROM STEELE COUNTY LINE TO NDSH #15	419.249	424.329	5.080	53,646	6,412	5,517				76
<b>CR #23</b>		<b>SUBTOTAL</b>		<b>5.080</b>	<b>0</b>	<b>6,412</b>	<b>5,517</b>	<b>0</b>	<b>0</b>	<b>0</b>	<b>76</b>

CR #25	FROM 23 <sup>RD</sup> ST. NE TO CR #5	443.196	450.251	7.055	74,508	9,314	5,724				
CR #25	FROM CR #5 TO RR TRACK AT REYNOLDS	450.251	453.270	3.019	31,872	3,984	1,586		133		
CR #25	FROM RR TRACKS AT REYNOLDS TO CR #81	453.270	455.037	2.038	18,660	1,972	9,055		133		152
<b>CR #25</b>		<b>SUBTOTAL</b>		<b>2.038</b>	<b>0</b>	<b>1,972</b>	<b>9,055</b>	<b>0</b>	<b>133</b>	<b>0</b>	<b>152</b>

Routes colored in green are NOT to have pavement marking.

This document was originally  
 Issued and sealed by  
 Nicholas J. West  
 Registration Number PE-5961  
 On 03-05-2020  
 Document is stored at the  
 Grand Forks County Highway  
 Department

**BASIS OF ESTIMATE**

PCN	STATE	PROJECT NO.	SHEET NO.
	ND	CWPM-1800(020)	12

ROUTE	LOCATION	FROM REF. POINT	TO REF. POINT	ROADWAY (MILES)	4" EDGE LINE (L.F.)	4" CENTERLINE (L.F.)	4" NPZ BARRIER (L.F.)	8" TURNING LANE (L.F.)	RR CROSSING (S.F.)	TURNING ARROW (S.F.)	STOP AHEAD MESSAGE (S.F.)
CR #26	FROM CR #25 TO CR #7	463.097	469.203	6.106	64,476	7,695	5,457				152
<b>CR #26</b>				<b>6.106</b>	<b>0</b>	<b>7,695</b>	<b>5,457</b>	<b>0</b>	<b>0</b>	<b>0</b>	<b>152</b>

32 <sup>ND</sup> AVE.	FROM 16 <sup>TH</sup> ST NE TO RR TRACKS	469.203	472.215	3.012	31,814	3,750	2,449		133		76
<b>32<sup>ND</sup> AVE.</b>				<b>3.012</b>	<b>0</b>	<b>3,750</b>	<b>2,449</b>	<b>0</b>	<b>133</b>	<b>0</b>	<b>76</b>

CR #33	FROM NDSH #18 TO CR #2	472.215	479.228	7.013	74,058	9,257	1,950		133		76
CR #33	FROM CR #2 TO U.S. #81	479.228	492.889	13.661	144,254	17,483	12,898		265		76
CR #33	FROM EAST SIDE OF I-29 OVERPASS TO DEAD END	492.889	495.713	2.824	29,822	3,714	4,421				
<b>CR #33</b>				<b>23.498</b>	<b>29,822</b>	<b>30,454</b>	<b>19,269</b>	<b>0</b>	<b>398</b>	<b>0</b>	<b>152</b>

Routes colored in green are NOT to have pavement marking.

This document was originally  
 Issued and sealed by  
 Nicholas J. West  
 Registration Number PE-5961  
 On 03-05-2020  
 Document is stored at the  
 Grand Forks County Highway  
 Department

**BASIS OF ESTIMATE**

PCN	STATE	PROJECT NO.	SHEET NO.
	ND	CWPM-1800(020)	13

ROUTE	LOCATION	FROM REF. POINT	TO REF. POINT	ROADWAY (MILES)	4" EDGE LINE (L.F.)	4" CENTERLINE (L.F.)	4" NPZ BARRIER (L.F.)	8" TURNING LANE (L.F.)	RR CROSSING (S.F.)	TURNING ARROW (S.F.)	STOP AHEAD MESSAGE (S.F.)
CR #81	FROM CR #25 TO CR#81A	495.713	502.758	7.045	74,392	9,056	4,829	130		16	
CR #81	FROM CR #81A TO 62 <sup>ND</sup> AVE. SOUTH	502.758	509.280	6.522	68,878	8,054	10,910	650		80	
CR #81A	FROM EAST SIDE OF 1-29 OVERPASS TO CR #81	509.280	509.280	0.347	3,664	324	1,784				76
<b>CR #81</b>	<b>SUBTOTAL</b>			<b>6.522</b>	<b>0</b>	<b>8,054</b>	<b>10,910</b>	<b>650</b>	<b>0</b>	<b>80</b>	<b>0</b>

**GRAND TOTAL**

**240.857**

**310,812**

**298,514**

**359,603**

**1,595**

**1,990**

**192**

**4,332**

Routes colored in green are NOT to have pavement marking.

This document was originally  
 Issued and sealed by  
 Nicholas J. West  
 Registration Number PE-5961  
 On 03-05-2020  
 Document is stored at the  
 Grand Forks County Highway  
 Department

### Pavement Marking Installation Detail

PCN	State	Project No.	Sheet No.
	ND	CWPM-1800(020)	14

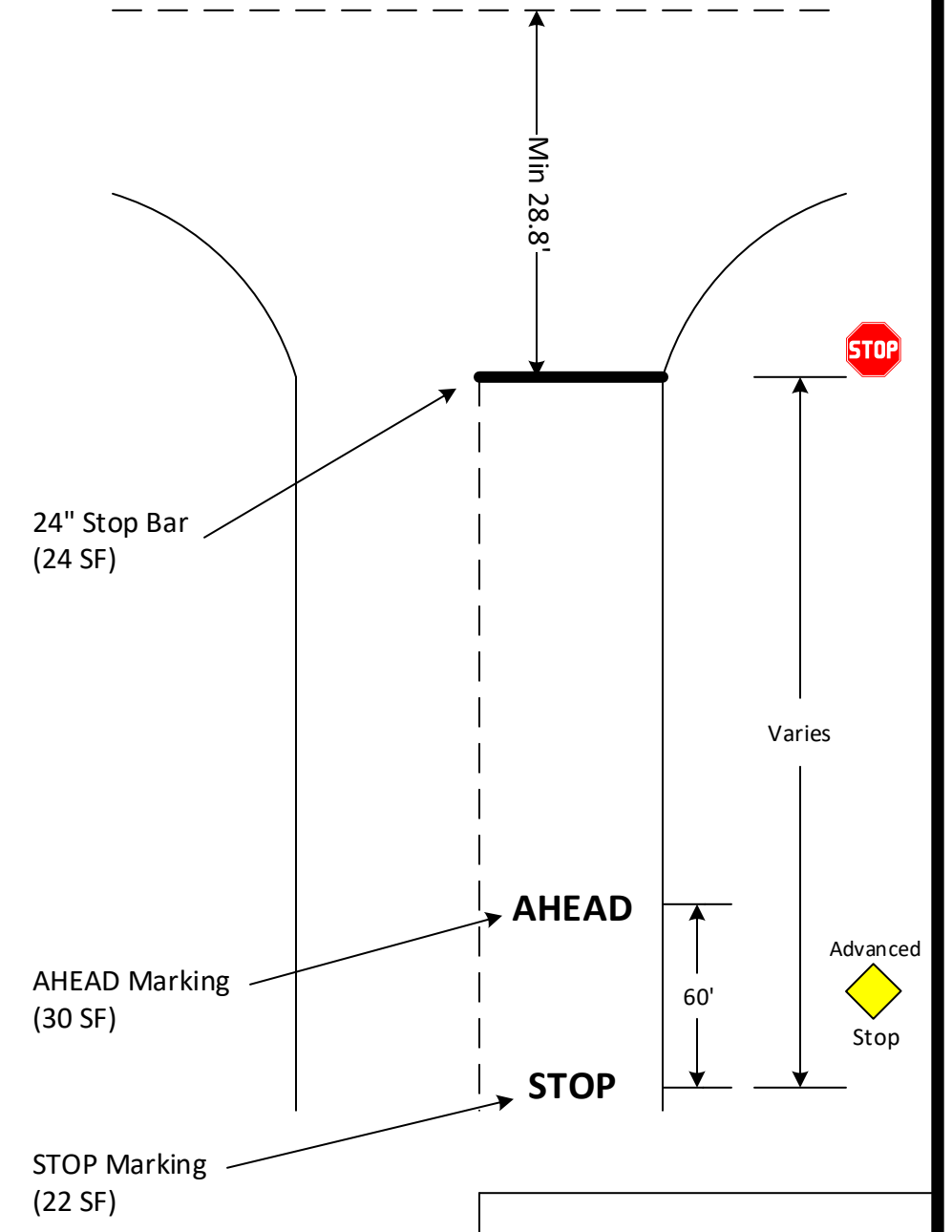
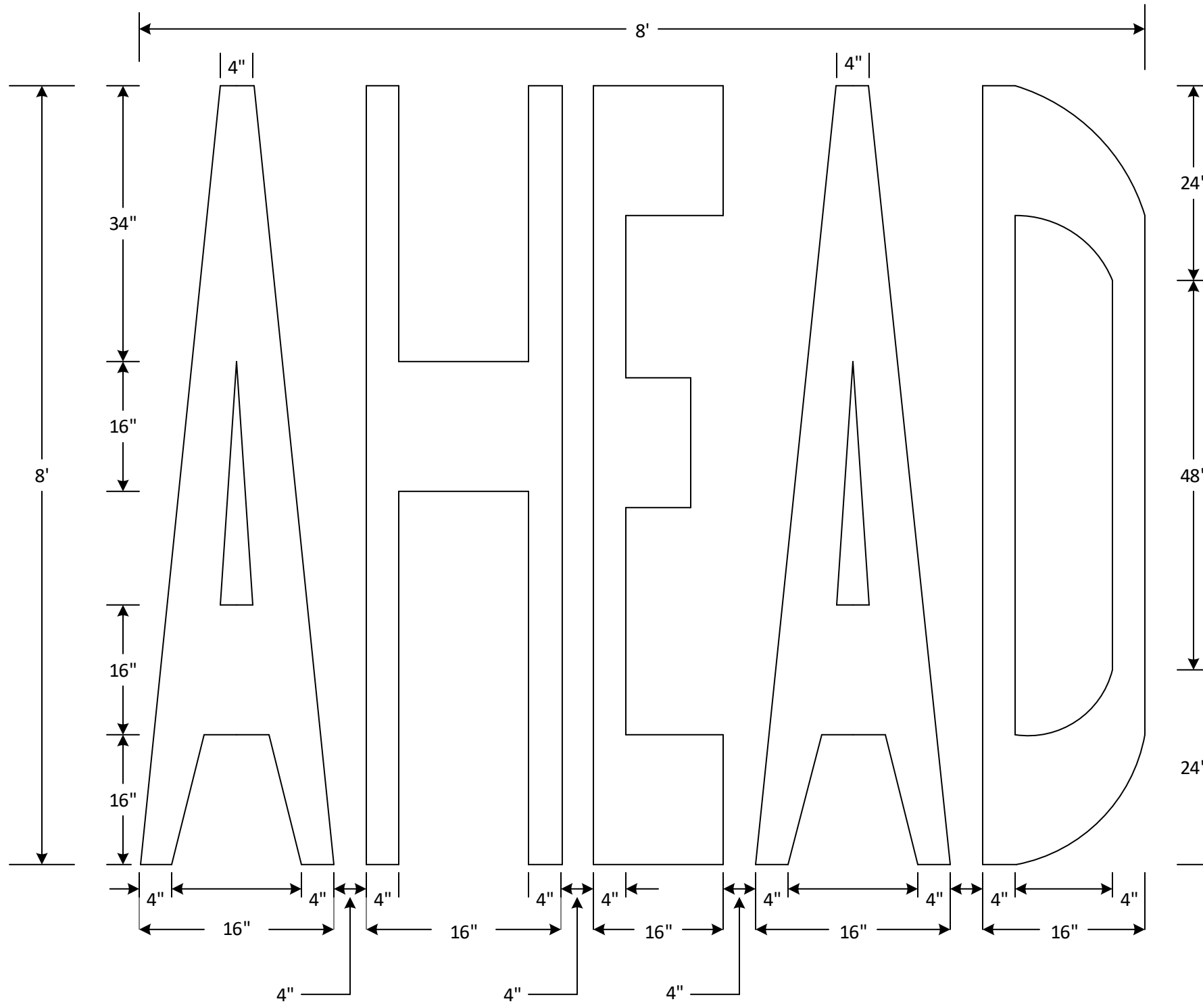

This document was originally  
Issued and sealed by  
Nicholas J. West  
Registration Number PE-5961  
On 03-05-2020  
Document is stored at the  
Grand Forks County Highway  
Department